

Panasonic

ENGLISH

FRANÇAIS

日本語

2" Electronic HD View Finder

AJ-HVF20P

AJ-HVF27P

Operating Instructions

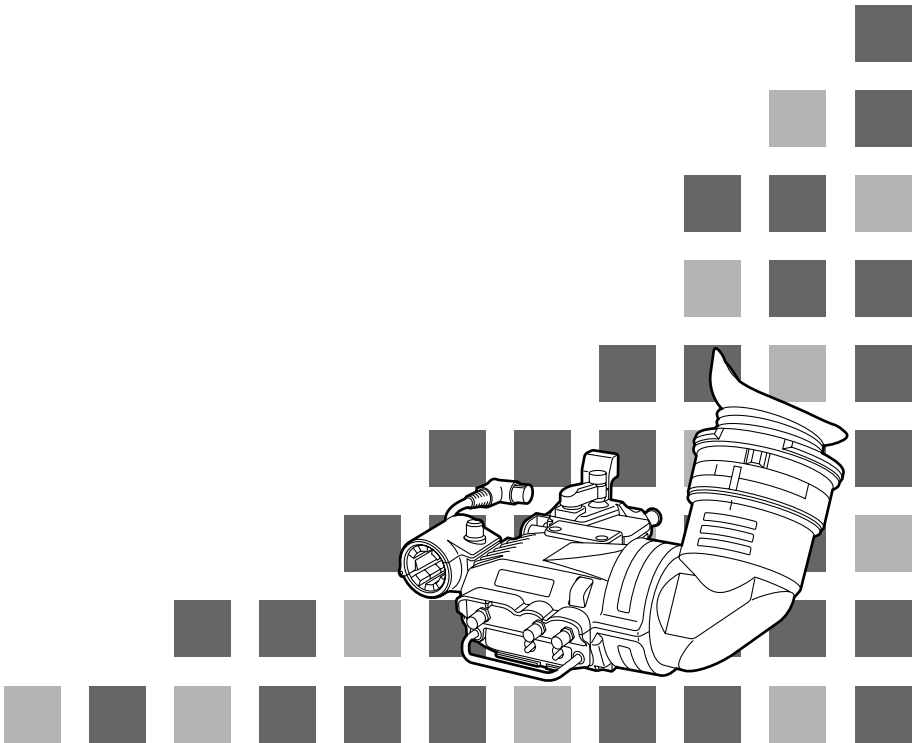

WARNING:

TO REDUCE THE RISK OF FIRE OR SHOCK HAZARD, DO NOT EXPOSE THIS EQUIPMENT TO RAIN OR MOISTURE.

Operating precaution

Operation near any appliance which generates strong magnetic fields may give rise to noise in the video and audio signals. If this should be the case, deal with the situation by, for instance, moving the source of the magnetic fields away from the unit before operation.

FCC Note:

This device complies with Part 15 of the FCC Rules. To assure continued compliance follow the attached installation instructions and do not make any unauthorized modifications.

This equipment has been tested and found to comply with the limits for a class A digital device, pursuant to Part 15 of the FCC Rules. These limits are designed to provide reasonable protection against harmful interference when the equipment is operated in a commercial environment. This equipment generates, uses, and can radiate radio frequency energy and, if not installed and used in accordance with the instruction manual, may cause harmful interference to radio communications. Operation of this equipment in a residential area is likely to cause harmful interference in which case the user will be required to correct the interference at his own expense.

Caution:

- The interior of this product contains high-voltage components. Do not disassemble the product.
- Be careful not to point the eyepiece directly at the sun.

 indicates safety information.

Contents

Features	<i>E- 3</i>
Specifications	<i>E- 3</i>
Parts and Their Functions	<i>E- 4</i>
Adjusting the Viewfinder	<i>E- 7</i>
Adjusting the Mounting Height of the Viewfinder	<i>E- 7</i>
Mounting the Viewfinder	<i>E- 8</i>
Detaching the Viewfinder	<i>E- 8</i>
Position Adjustment	<i>E- 9</i>
Diopter Adjustment	<i>E- 10</i>
Screen Adjustment	<i>E- 10</i>
Detaching the Eyepiece	<i>E- 11</i>
Mounting the Microphone	<i>E- 12</i>

Features

- The high-resolution CRT delivers superb picture sharpness, making focusing easier.
- The low-flare CRT makes the screen clear and easy on the eyes.
- The large eyepiece aperture makes it possible to see the screen even when holding the viewfinder at some distance from your eye.
- The eyepiece is easily detachable.
- Easy, one-touch left-right and forward-backward position adjustment.

Specifications

Power supply:	DC 12 V (supplied by camera)
Power consumption:	3.3 W (AJ-HVF20P)
	3.8 W (AJ-HVF27P)

Picture tube:

2-inch high-resolution monochrome picture tube

Image system:

1080 lines, 59.94 Hz (AJ-HVF20P)

720 lines, 59.94 Hz (AJ-HVF27P)

External adjustment controls:

Controls (BRIGHT, CONTRAST, PEAKING)

Switches (TALLY HIGH/OFF/LOW, ZEBRA ON/OFF)

Allowable temperature range:

32°F to 104°F (0°C to 40°C)

Allowable humidity range:

85% or less (no condensation)

External dimensions (W×H×D):

9 1/2"×3 3/16"×8 1/8" (240×80×206 mm)

Weight:

2.112 lb (960 g)

Parts and Their Functions

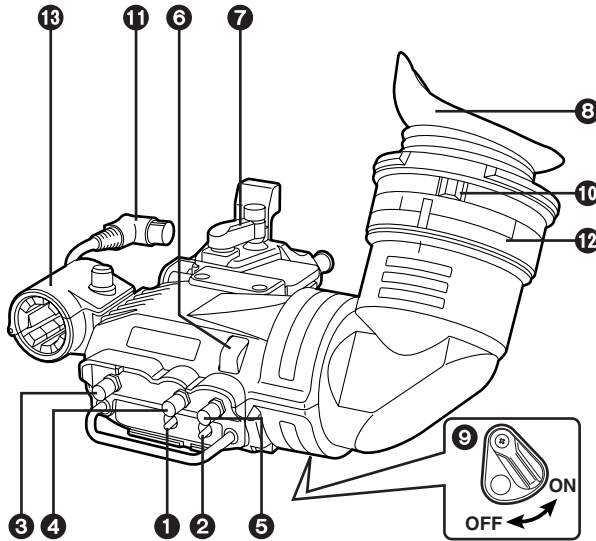

1 ZEBRA (Zebra Pattern) Switch

Displays a zebra pattern inside the viewfinder.

ON: Displays a zebra pattern.

OFF: No zebra pattern displayed.

The details of the display, such as the type of zebra pattern, will differ depending on the camera used with the viewfinder. Refer to the instruction manual of the camera for details.

2 TALLY Switch

Controls the front tally lamp.

HIGH: Makes the front tally lamp brighter.

OFF: Turns the front tally lamp off.

LOW: Makes the front tally lamp dimmer.

3 PEAKING Knob

Adjusts the outlines of the images in the viewfinder to make focusing easier. The setting of this control has no effect on the output signal of the camera.

4 CONTRAST Knob

Adjusts the contrast of the screen inside the viewfinder. The setting of this control has no effect on the output signal of the camera.

Parts and Their Functions

5 BRIGHT (Brightness) Knob

Adjusts the brightness of the screen inside the viewfinder. The setting of this control has no effect on the output signal of the camera.

6 Front Tally Lamp

Lights when the VTR is recording and the TALLY switch is set to HIGH or LOW. Also, flashes on and off as a warning indication, in the same manner as the REC lamp, inside the viewfinder.

The brightness of the front tally lamp is controlled by the setting of the TALLY switch (HIGH or LOW).

7 Viewfinder Forward-Backward/Left-Right Position Clamp Lever

Loosen this lever to adjust the viewfinder position in the forward, backward, right or left direction.

8 Eyepiece

9 Back Tally Lamp

Lights when the VCR is recording. Also, flashes on and off as a warning indication, in the same manner as the REC lamp inside the viewfinder.

The back tally lamp is hidden when the lever is in the OFF position.

10 Diopter Adjustment Ring

Adjust this control to match the vision of the person using the camera so that the image on the screen in the viewfinder is as clear as possible.

11 Connection Plug

12 Lock Ring

13 Microphone Holder

Parts and Their Functions

Internal LEDs

The lamp and picture tube indications will differ depending on the camera used with the viewfinder.

Refer to the instruction manual of the camera for details.

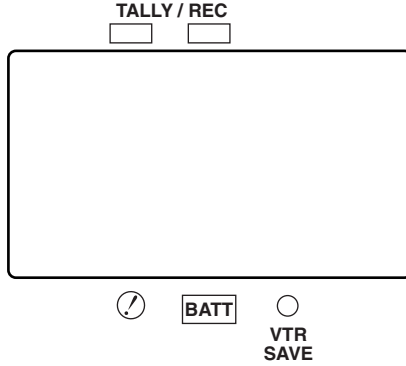

Adjusting the Viewfinder

Adjusting the Mounting Height of the Viewfinder

The mounting height of the viewfinder can be adjusted using the method described below.

Adjust the height of the mounting unit as required.

- At the time of shipping, the mounting height is set for use with the AJ-HDC20A and AJ-HDC27A models.

• Adjusting the height of the mounting unit

1. Detach the two screws, then detach the mounting unit.

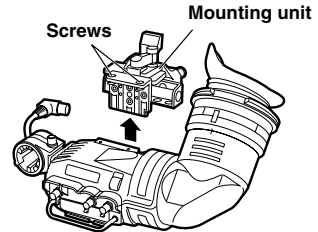

2. Replace the three screws in the positions indicated as **A** or **B** from the present positions and change the position of the metal fitting.

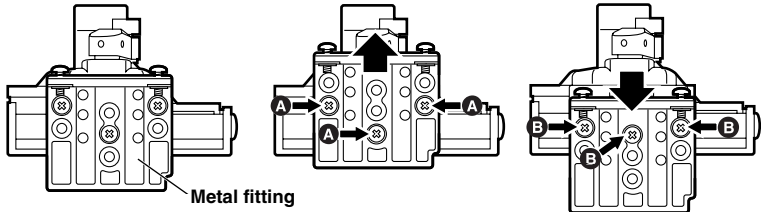

Re-fix the metal fitting by fastening the screws together with the spring washer.

3. Secure the mounting unit in place with the two screws.

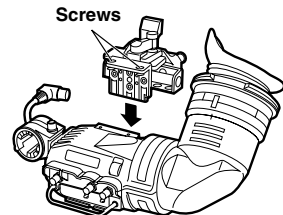

Adjusting the Viewfinder

Mounting the Viewfinder

1. Confirm that the POWER switch of the camera is "OFF".
2. Insert the plug into the connection jack of the viewfinder.
<Note>
 Be sure to insert the plug all the way into the connection jack.
3. Push the viewfinder down into place.
4. Tighten the stopper screw firmly.

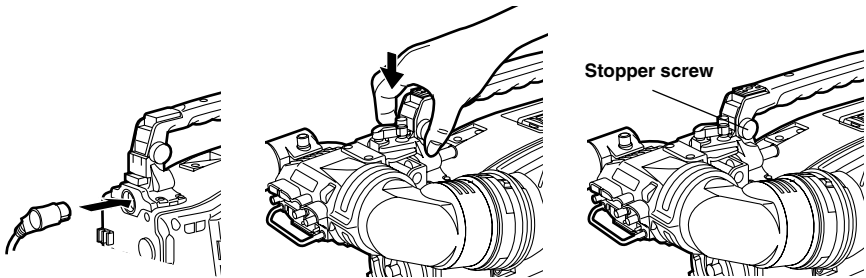

Detaching the Viewfinder

1. Confirm that the POWER switch of the camera is "OFF".
2. Loosen the stopper screw and detach the viewfinder by pulling it straight up.
<Note>
 Use both hands to detach the viewfinder. The viewfinder may not detach smoothly with one hand, resulting in damage to the viewfinder.
3. Disconnect the connection jack from the viewfinder cable connector.

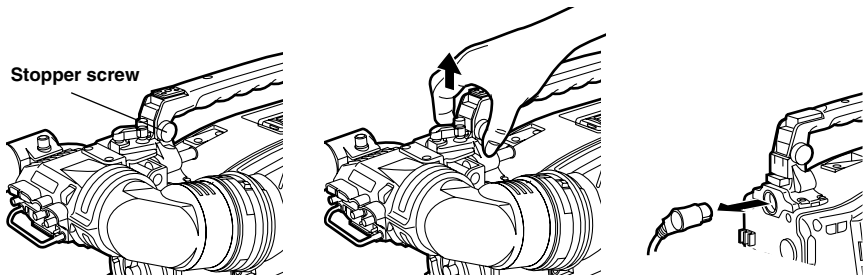

Adjusting the Viewfinder

Position Adjustment

1. Lift up the viewfinder forward-backward/left-right position clamp lever to disengage the lock.

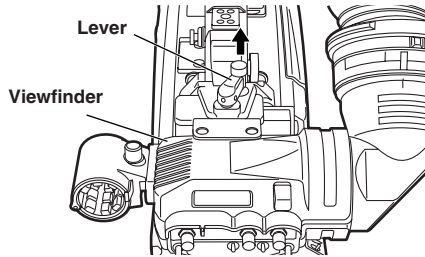

2. Loosen the viewfinder forward-backward/left-right position clamp lever.

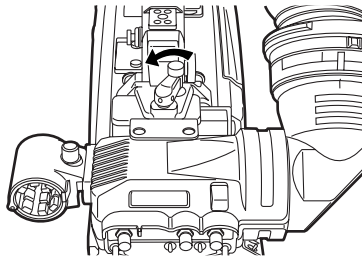

3. Adjust the position of the viewfinder by moving it forward, backward, left or right.

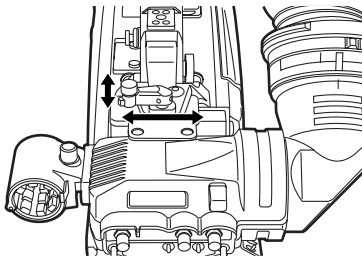

4. Return the viewfinder forward-backward/left-right position clamp lever to the locked position.

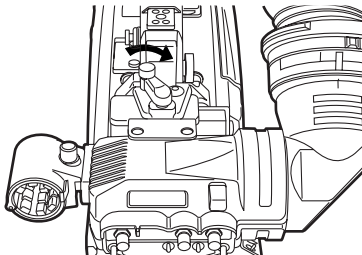

Adjusting the Viewfinder

Diopter Adjustment

1. Set the POWER switch of the camera to “ON”. A picture will appear in the viewfinder.
2. Turn the diopter adjustment ring to adjust the diopter so that the viewfinder picture can be clearly seen.

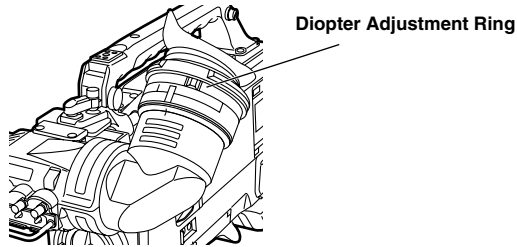

Screen Adjustment

Adjust the condition of the viewfinder screen.

Brightness: Adjust the BRIGHT control.

Contrast: Adjust the CONTRAST control.

Contour: Adjust the PEAKING control.

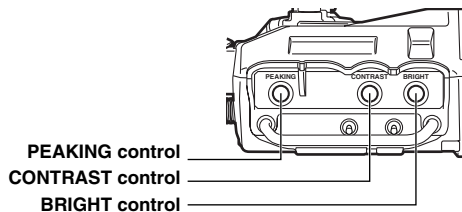

1. Set the POWER switch of the camera to “ON”.
2. Set the OUTPUT switch of the camera to “BAR”.
3. Turn the viewfinder BRIGHT and CONTRAST controls to adjust the picture brightness and contrast.
Turning the PEAKING control makes the picture appear sharper.
A sharper picture facilitates focusing the lens.

Adjusting the Viewfinder

Detaching the Eyepiece

If dust has adhered to the CRT screen or mirror, detach the eyepiece and remove it.

<Note>

Do not wipe the mirror surface under any circumstances as it has been specially treated. Dust which has adhered to the mirror should be blown away with a blower, etc.

1. Turn the lock ring as far as possible in the clockwise and counterclockwise directions to line up the alignment marks on the lock ring and viewfinder barrel.

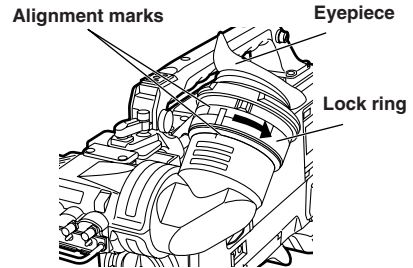

2. Detach the eyepiece.

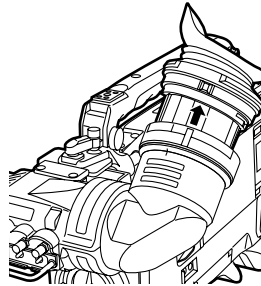

Remounting the Eyepiece

1. Line up the alignment marks on the lock ring and the viewfinder barrel and slide the eyepiece back into place.
2. Turn the lock ring clockwise as far as the **◀LOCK** position.

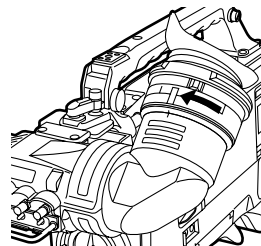

Mounting the Microphone

Follow the steps below to install the AJ-MC700P microphone kit (sold separately).

1. Open the microphone holder.

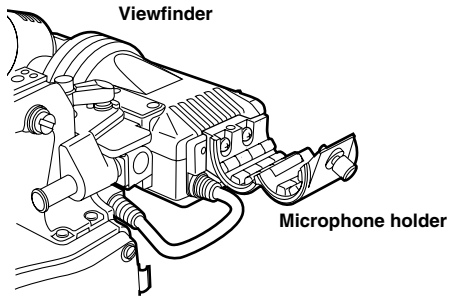

2. Mount the microphone.

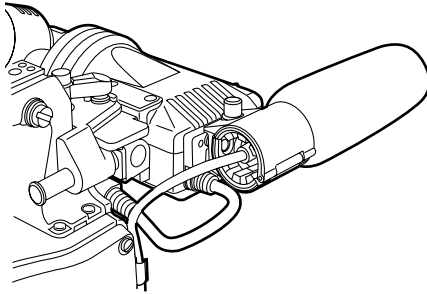

3. Plug the microphone connector cable into the MIC IN jack.

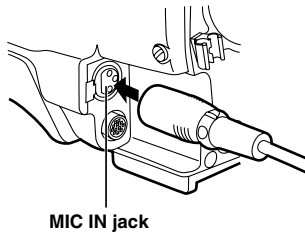

Panasonic

PANASONIC BROADCAST & TELEVISION SYSTEMS COMPANY
DIVISION OF MATSUSHITA ELECTRIC CORPORATION OF AMERICA

Executive Office:

3330 Cahuenga Blvd W., Los Angeles, CA 90068 (323) 436-3500

EASTERN ZONE:

One Panasonic Way 4E-7, Secaucus, NJ 07094 (201) 348-7621

Southeast Region:

1225 Northbrook Parkway, Ste 1-160, Suwanee, GA 30024 (770) 338-6835

Central Region:

1707 N Randall Road E1-C-1, Elgin, IL 60123 (847) 468-5200

WESTERN ZONE:

3330 Cahuenga Blvd W., Los Angeles, CA 90068 (323) 436-3500

Government Marketing Department:

52 West Gude Drive, Rockville, MD 20850 (301) 738-3840

Broadcast PARTS INFORMATION & ORDERING:

9:00 a.m. – 5:00 p.m. (EST) (800) 334-4881/24 Hr. Fax (800) 334-4880

Emergency after hour parts orders (800) 334-4881

TECHNICAL SUPPORT:

Emergency 24 Hour Service (800) 222-0741

Panasonic Canada Inc.

5770 Ambler Drive, Mississauga, Ontario L4W 2T3 (905) 624-5010

Panasonic de Mexico S.A. de C.V.

Av angel Urraza Num. 1209 Col. de Valle 03100 Mexico, D.F. (52) 1 951 2127

Panasonic Sales Company

Division of Matsushita Electric of Puerto Rico Inc.

San Gabriel Industrial Park, 65th Infantry Ave., Km. 9.5, Carolina, Puerto Rico 00630 (787) 750-4300

松下電器産業株式会社 放送システム事業部

☎ 571-8503 大阪府門真市松葉町2番15号 ☎ (06) 6901-1161